



Howard Morley  
& Sons

PER MONTH

**£5,950 Per Month**

**Burrows Lane**

Guildford, GU5 9QF



Approximate Gross Internal Floor Area = 188.0 sq m / 2024 sq ft

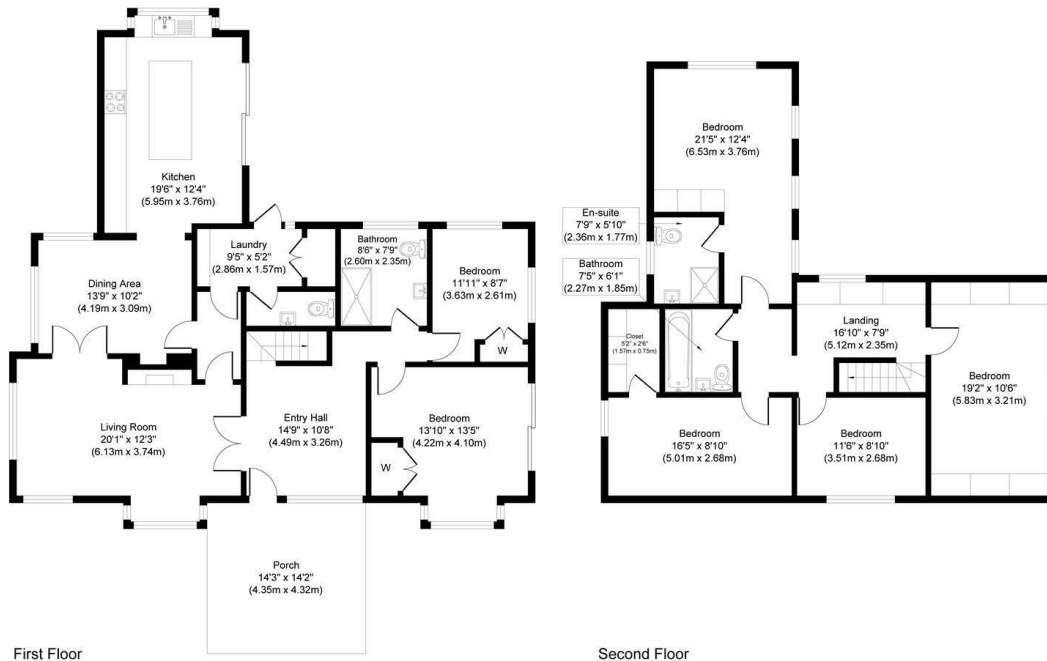

6 

3 

2 

Energy Efficiency Rating		Current	Potential
Very energy efficient - lower running costs			
(92 plus)	A		
(81-91)	B		
(69-80)	C	80	83
(55-68)	D		
(39-54)	E		
(21-38)	F		
(1-20)	G		
Not energy efficient - higher running costs			
England & Wales		EU Directive 2002/91/EC 	

Agents Note: Whilst every care has been taken to prepare these particulars, they are for guidance purposes only. All measurements are approximate and are for general guidance purposes only and whilst every care has been taken to ensure their accuracy, they should not be relied upon and potential buyers/tenants are advised to recheck the measurements

	<p><b>OFFICE ADDRESS</b>                  276 High Street                  Guildford                  Surrey                  GU1 3JL</p>	<p><b>OFFICE DETAILS</b>                  01483 575 304                  lettings@hmorley.co.uk                  hmorley.co.uk</p>
---	---	--